

May 18, 1990

INTRODUCED BY:

DAVID POLLEN
BRUCE LAING

PROPOSED NO.:

90 - 520

ORDINANCE NO. **9513**

AN ORDINANCE changing the boundary of the Sewer Local Service Area in the Tahoma/Raven Heights Communities Planning area due to a documented public health hazard and amending Ordinance 6986 Appendix A and the King County Sewerage General Plan (Ordinance 4035).

PREAMBLE:

For the purpose of effective planning and regulations, the King County Council finds:

1. The Shadow Lake and Cedar River elementary schools, located outside of the Sewer Local Service Area in the Tahoma/Raven Heights Communities Planning Area, are creating a public health hazard due to drainfield failures.
2. The Seattle-King County department of public health verifies this public health hazard and further states that the only remedy is the installation of sanitary sewers.
3. The King County Sewerage General Plan requires the local sewer agency to demonstrate an existing or potential health hazard and that alternative methods of sewage disposal are financially and technically infeasible.
4. The Tahoma/Raven Heights Communities Plan calls for alternative sewage systems outside the Sewer Local Service Area unless they are demonstrated to be financially or technically infeasible.
5. The Soos Creek Water and Sewer District does substantiate the public health hazard and the necessity to provide sewer service to the area.
6. The Board of Commissioners of the Soos Creek Water and Sewer District passed Resolution 0466-S which indicates the district's willingness and ability to provide the sewer service.
7. The Tahoma School District has studied alternative sewage disposal methods and demonstrated that there are none which are financially or technically feasible.
8. The Tahoma School District and the Soos Creek Water and Sewer District agree that no other connections will be allowed to this tightline.

BE IT ORDAINED BY THE COUNCIL OF KING COUNTY:

SECTION 1. Ordinance 6986, Appendix A is hereby amended.

The Sewer Local Service Area boundary is changed to include the property depicted on Attachment A and legally described in Section 3. No other properties shall be served.

1 SECTION 2. Ordinance No. 4035 previously adopting the King
2 County Sewerage General Plan is hereby amended pursuant to the
3 depiction on Attachment A and the legal description in
4 Section 3.

5 SECTION 3. The area to be included in the Local Service
6 Area boundary adjustment is described as follows:

7 That portion of the North one-half of the North one-half of
8 Section 16, Township 22 North, Range 6 East, W.M., in King
County, Washington, more particularly described as follows:

9 Beginning at the North one-quarter corner of said Section 16;

10 Thence Southeasterly, along the Southwesterly line of the
11 City of Seattle pipeline right-of-way as condemned in
12 Superior Court, State of Washington, County of King, Cause
13 No. 128004, Judgement and Verdict entered June 18, 1919, to a
14 point lying 615.00 feet Northwesterly from the intersection
15 of said Southwesterly line with the Westerly right-of-way
16 line of Petrovitsky Road Extension (aka Petrovitsky Road
Southeast), as located by Survey No. 6-22-6-3 and shown on
King County department of public works plan sheet 301-87H,
said point being the Northwesterly corner of that parcel
conveyed and quitclaimed to Tahoma School District Number 409
by the City of Seattle by document executed on July 5, 1979,
and recorded at Auditor's File No. 7910090863, records of
said King County;

17 Thence Easterly, to the Northeasterly corner of said parcel
18 conveyed and quitclaimed to Tahoma School District No. 409,
19 said corner being on said Westerly right-of-way line of
20 Petrovitsky Road Extension and lying 264.06 feet Southeast-
erly from the intersection of said Westerly right-of-way line
with the North line of said Section 16;

21 Thence Southerly, along said Westerly right-of-way line of
22 Petrovitsky Road Extension, to the South line of the North-
west one-quarter of the Northeast one-quarter of said
Section 16;

23 Thence Westerly, to the Southwest corner of said Northwest
24 one-quarter of the Northeast one-quarter;

25 Thence Westerly, to the Southwest corner of the Northeast
26 one-quarter of the Northwest one-quarter of said Section 16;

1 Thence Northerly, to the Northwest corner of said Northeast
2 one-quarter of the Northwest one-quarter;

3 Thence Easterly, to the Point of Beginning.

4 Subject to all roads, easements and rights-of-way, existing
5 and/or of record.

6 INTRODUCED AND READ for the first time this 11th day of

June, 1990.

7 PASSED this 2nd day of July, 1990.

8 KING COUNTY COUNCIL
9 KING COUNTY, WASHINGTON

10
11 Rois North
12 Chair

13 ATTEST:

14 Gerald A. Peterson
15 Clerk of the Council

16 APPROVED this 9th day of July, 1990.

17
18 Russ R. ...
19 for King County Executive

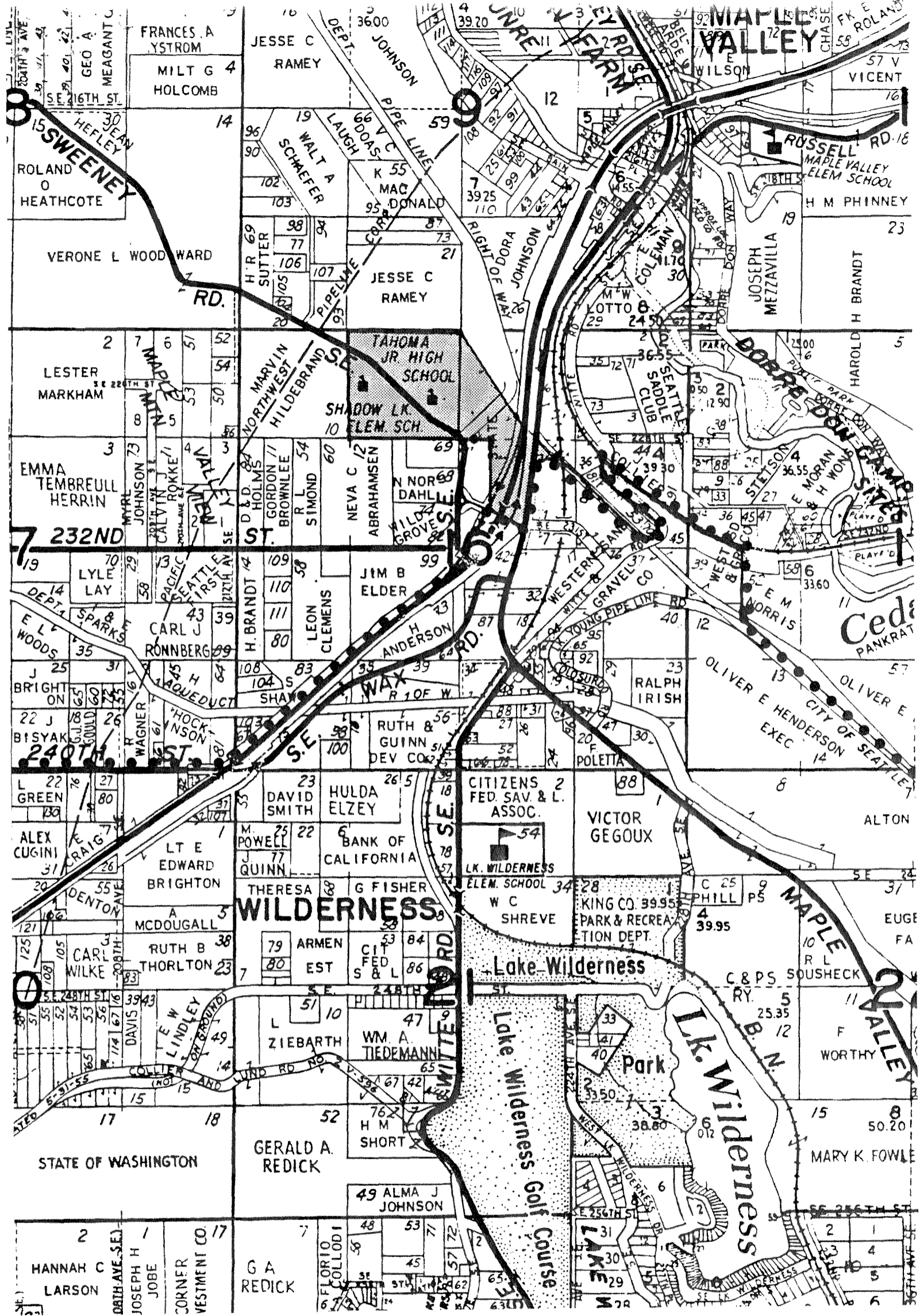

N

LEGEND

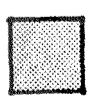

PROPOSED ADDITION TO LOCAL SERVICE AREA



EXISTING LOCAL SERVICE AREA BOUNDARIES

9513